

## Tools Required

Modellers Knife (with a fresh blade)

Cutting Mat

Modelling Glue (we recommend Deluxe Materials Roket Card Glue)

Fine Tip Applicator

Low-tac Masking Tape

Clips / Clamps

## Tips

Prior to starting your build, we recommend reading through the instructions to familiarise yourself with the build style of the kit.

We recommend painting any white edges as you remove the components from the sheet to improve the finished look. We advise watercolour paints for the best finish.

Each component is held in the sheet using score lines, indicated by a scissor symbol. To remove the component from the sheet, carefully run the tip of your modelling knife through the score line.

Remove each component as it is required to prevent losing or mixing it up with another component.

Ensure that glue is distributed evenly and not too close to the edge as it may ooze out when pressure is applied.

Use low-tac masking tape, clamps and weights to aid the assembly process.

1. Detach component A and place it face down on your work surface. Then, locate the glazing sheet, cut out the three windows and glue them into position.

Optional: Carefully run the blade of your modelling knife down the scored line on the door to achieve an 'open' look.

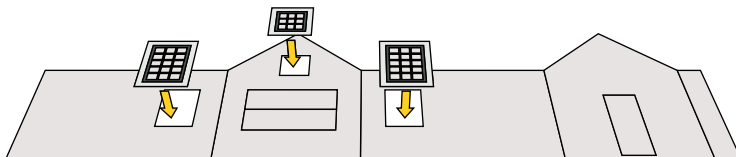

2. Fold the crease lines on component A. Next, apply glue to the tab and bond it to the inside of the adjacent wall. This will form the shell of the stall.

3. Open the window shutter by folding the top crease outwards. Then, fold the lower section of the shutter underneath the upper section and glue them together.

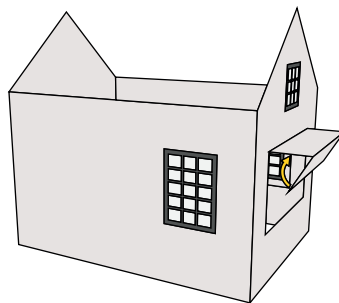
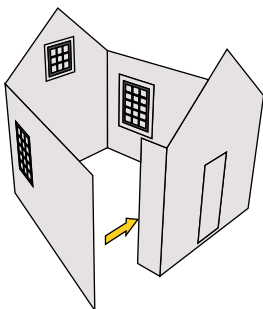

4. Detach component B and place it face down on your work surface. Then fold the crease lines and glue the two tabs to the floor. This will form the counter tops.

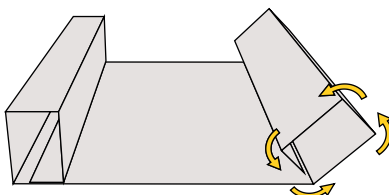

5. Apply glue to two of the outer edges of component B. Then, carefully slide component B inside component A.

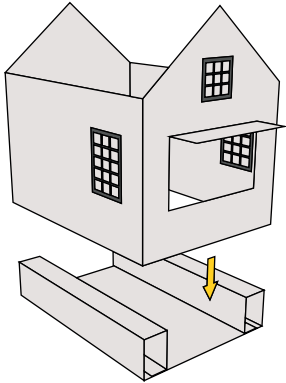

6. Detach component C and fold the crease lines. Then, apply glue to the two tabs and position it below the serving window, between the two counters.

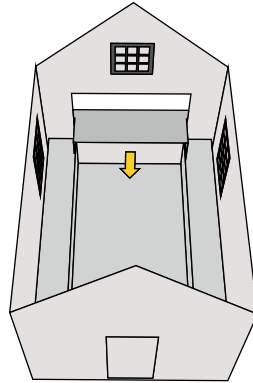

7. Carefully apply a bead of glue across the top of all four walls. Then, detach component D, fold it along the crease line to form the roof and position on top of the stall.

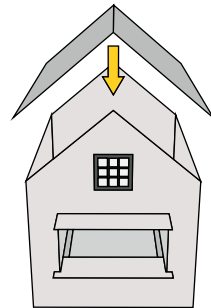

You have now completed the Traditional Market Stall. We hope you enjoyed and successfully built the kit! To view our other card kits, more products and find your local stockist, visit [www.atdmodels.co.uk](http://www.atdmodels.co.uk)

We'd love to see photos of your finished models. Please send them to [enquiries@atdmodels.co.uk](mailto:enquiries@atdmodels.co.uk) for a chance to be featured on our social media pages.

